

WHY DO YOU NEED SOLITEX EXTASANA®?

Optimum weathertightness protection under all weather conditions for your walls

SOLITEX EXTASANA® is extremely high diffusion open due to the active diffusion function and has high water resistance under all climatic conditions, offering the ultimate weathertightness protection during construction and for the lifetime of the building.

- ✓ New generation wall underlay
- ✓ Waterproof
- ✓ Windproof
- ✓ Highly diffusion permeable
- ✓ High resistance to driving rain
- ✓ UV stabilised up to 90 days
- ✓ High tear resistance
- ✓ Can be used as an Air Barrier

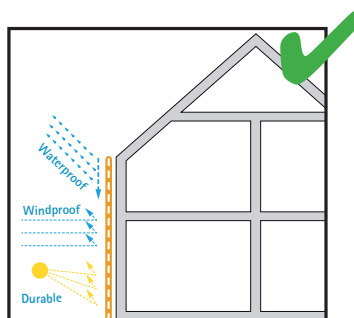
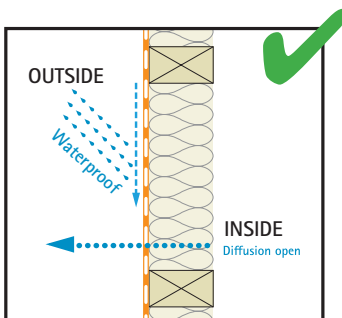

WHAT DOES SOLITEX EXTASANA® DO FOR YOU?

SOLITEX EXTASANA® protects the building envelope against driving rain and optimises protection against condensation risks. SOLITEX EXTASANA® is absolutely watertight and non-porous yet has high diffusion permeability.



System Products



SOLITEX EXTASANA® Installation Instructions

SOLITEX EXTASANA® is installed directly to the outside of the external timber or steel wall framing, using staples, tape or adhesive.

Please note:

- The recommended tape for sealing the overlapping joints or connections to smooth non-mineral adjoining surfaces is pro clima TESCON EXTORA®.
- For connections to rough adjoining structural components or mineral surfaces, the pro clima ORCON adhesive is recommended.
- Overlaps of SOLITEX EXTASANA® must be a minimum of 150 mm and taped with pro clima TESCON EXTORA® to increase weather-tightness.

Roll out and fix membrane



Fix SOLITEX EXTASANA® securely to the frame at 300 mm centres horizontally and vertically.

Vertical overlaps



A minimum of 150 mm is required at vertical overlaps.

Cut membrane at opening

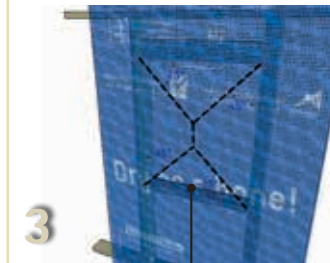

Cut SOLITEX EXTASANA® at 45° to corners of openings.

Fold membrane into opening

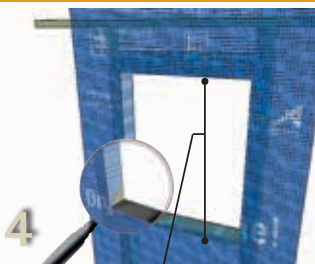

Fold SOLITEX EXTASANA® into the opening and secure to framing.

Seal membrane to window joinery



Apply TESCON EXTORA® weathertight sealing tape to window joinery.

Sealing penetrations



Use pro clima ROFLEX to seal pipe penetrations and pro clima KAFLEX for cable penetrations.

Technical data

Cover-fleece + protective-layer:	PP microfibre fleeces
Membrane:	monolithic TEEF film, waterproof, non-porous, diffusion open
Colour:	dark blue
Surface weight:	140 g/m ² ± 5g/m ²
Temperature resistance:	-40 °C to +100 °C
μ (for WUFI calculations):	145
Thickness:	0.60mm ± 0.05mm
Water column:	> 10,000 mm
Resistance to water penetration:	pass
UV stability and outdoor exposure:	90 days
Flammability:	fire retardant
Shrinkage:	can be used for the maximum run length
Tensile strength MD/CD:	> 4 kN/m (MD); > 3 kN/m (CD)
Edge-tear resistance MD/CD:	> 200 N (MD); > 150 N (CD)
Absorbency:	> 100 g/m ²
ph:	6.7
Air resistance:	> 0.1 MNs/g ²
MVTR-value:	< 0.75 MNs/g

All independent tests have been carried out by SCION and NZWTA.

Connecting to rough or mineral surfaces



Use pro clima ORCON CLASSIC to adhere SOLITEX EXTASANA® to rough adjoining structural components or mineral surfaces.



Packaging

Roll length	Roll width	Roll area	Roll weight
36.5 m	1.50 m	55 m ²	8.5 kg
36.5 m	2.74 m	100 m ²	16 kg

Your local support

Pro Clima Australia Pty Ltd
PO Box 924, Gosford, NSW 2250
Freephone: 1800 PRO CLIMA (776 254)
Email: support@proclima.com.au